



When ordering repair parts, please provide the following information:

1. Model Number
2. Part Number
3. Part Description
4. Finish Color

INSTALLATION INSTRUCTIONS

MODEL: CD Door NEO Pack

Neo Panel Pack for Cardinal Series
Continuous Hinge Swing Door

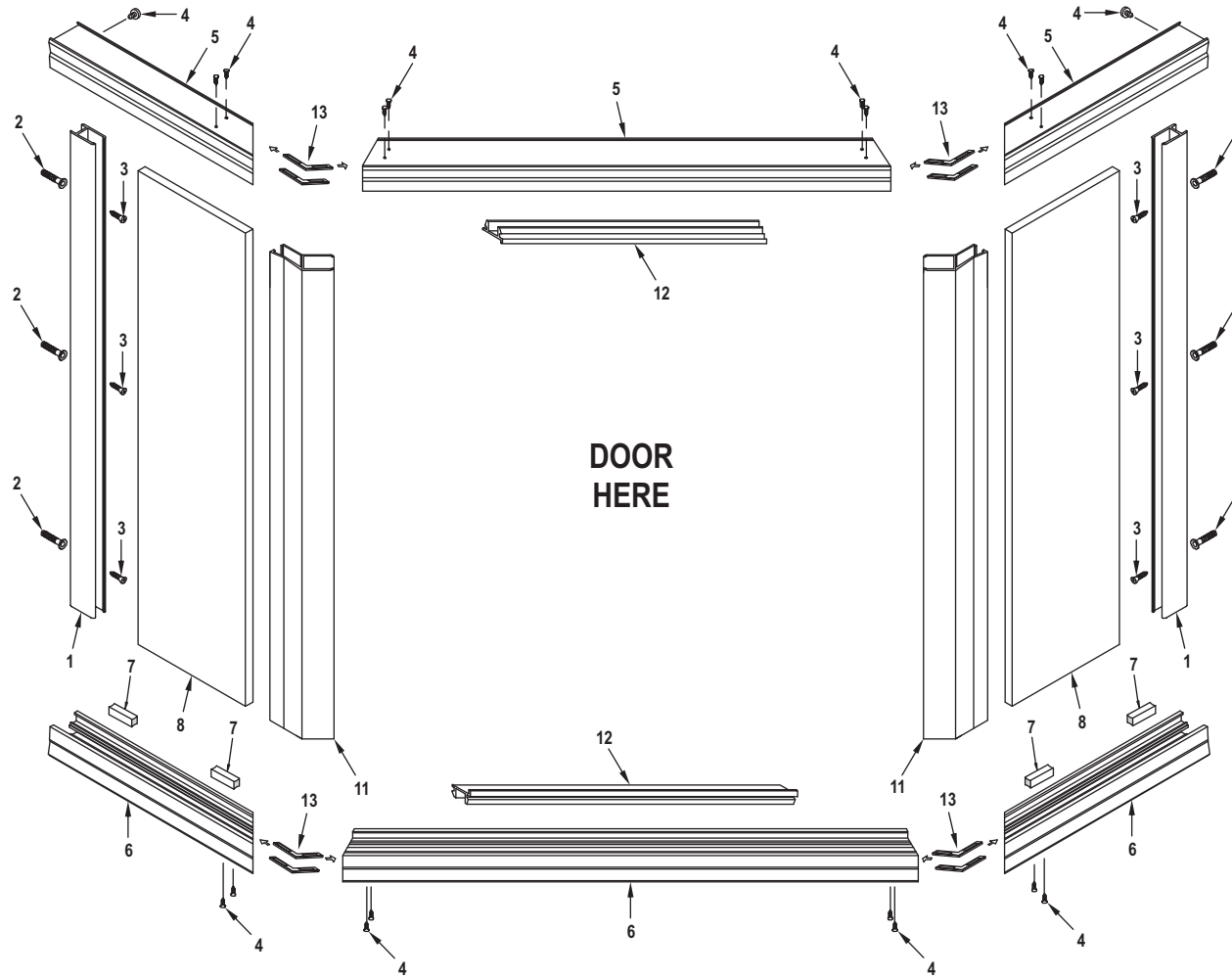

DESCRIPTION	QTY	PART NO.	PICTURE
1. Wall Channel*	2	ZD-1006	
2. Wall Anchor*	6	ZV-935	
3. #8 x 1-1/4" Screw*	6	#8X1-1/4	
4. #6 x 3/8 Screw	26	#6X3/8	
5. Header (Mitered 22.5 Degrees)	3	ZSS-3101	
6. Curb (Mitered 22.5 Degrees)	3	ZSS-3101	
7. Glass Support Block	4	ZV-902	
8. 135 Degree Glass Panel	2		
9. Vertical Seal Vinyl	8	ZV-909	
10. Horizontal Seal Vinyl	8	ZV-906	
11. 135 Degree Corner Post	2	ZSS-1105	
12. Header and Curb Fillers	2	ZSS-1102	
13. 135 Degree Header/Curb Clips	8	ZC-135	

*Note: Items 1, 2 and 3 come with door stall wrap

REQUIRED TOOLS

To install your shower enclosure, you will need the following:

- Level
- #31 Drill Bit
- 3/16" Carbide Drill Bit (for tile walls)
- Phillips Screwdriver
- Silicone
- Hack Saw
- 1/4" Box End Wrench

NOTE: Wall channels (1), wall anchors (2) and screws (3) that are used in stall shower instructions are shipped with the shower door. Read both door and stall instructions before starting installation.

1. Add 3/8" to centerline measurement for center section, and 3/16" to centerline measurement for sides. Cut both header and curb center sections to size. Also cut the curb side sections, leaving the header sections for later.
2. Assemble header and curb with slips provided (Figure 1). Using holes provided in header and curb, secure using eight #6x3/8" SMS Screws (4). Set curb in place and mark location on curb leaving curb in place temporarily.
3. Set wall channels into curb and mark holes on wall. Remove wall channels and curb and drill holes into wall using 3/16" drill bit. Place screw anchors into holes.
4. Run a 1/4" bead of silicone on underside of curb, over miters, and where the ends of the curb sits on the threshold.
5. Replace curb and silicone where miters are and where curb meets wall. Replace the wall channels and secure using #8x1-1/4" SMS Screws (3).
6. Place glass support blocks in curb and set panel glass in place, tacking at top with about 6" of the vertical seal vinyl. To adjust for wall conditions, adjust the panel in or out of the post, making sure that at least 1/4" remains in each channel.
7. Place corner post in place on other edge of glass and tack in place using vertical seal vinyl. Plumb corner post to the respective wall.
8. Check the chart for the door size, and obtain the range for the curb filler. If the distance between the wall channel and the corner post falls within this range, then cut curb filler to size. If the measurement does not fall into the range, then a larger or smaller door is needed. Cut curb filler to size and snap in place higher lip to outside of unit.

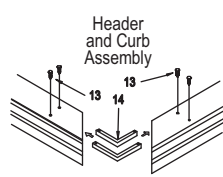

Figure 1

9. To cut header sides to length, measure from wall to the outside point of angle on corner post, then add 1/8" to this measurement. This length is the outside dimension of the header from the miter point to the wall.

(REFER TO SHOWER DOOR INSTALLATION INSTRUCTIONS)

10. Snip excess vinyl from latch jamb and crimp in place at top and bottom. Holding corner post, slip latch jamb into place.
11. Install 3" vinyl channel, centered on edge of glass, and tap handle in place.
12. Set door (with hinge jamb attached) over corner post. Secure hinge jamb to corner post using adjustment derived at from step #8. Use a #31 drill bit and #6x3/8" SMS Screw (4).
13. Stand inside shower and pull door closed. If, when you pull the door closed without creating pressure on the latch jamb vinyl, there is an opening at the top, you must decrease the length of the header over the fixed panel side where the door is hanging. If the gap is at the bottom, then you need to shorten the length of the header over the fixed panel side where the door latches.
14. Using a #31 latches and #6x3/8" SMS Screw (4), secure header to wall channels.
15. Adjust header up or down on corner post to make parallel with the top of door. Now, using a #31 drill, secure with #6x3/8" SMS Screw (4) to corner post.
16. Install the rest of the vertical seal vinyl at post and wall channels, and horizontal seal vinyl in header and curb.
17. Recheck alignment of door and corner post. If out, adjust by tapping on corner post.
18. Adjust latch jamb for a gap of 3/16" for latch to edge of door.
19. Install magnet on latch jamb.
20. Adjust splash vinyl so that approximately 1/8" daylight space remains between bottom of splash vinyl and curb filler with the door in the closed position.
21. Seal along inside and outside edge of metal and tile with silicone.

Header & Curb Fillers		
Min Filler = Door Size - 1 7/8"		
Max Filler = Door Size - 1 7/8"		
CD-20	18 1/8"	19 1/8"
CD-21	19 1/8"	20 1/8"
CD-22	20 1/8"	21 1/8"
CD-23	21 1/8"	22 1/8"
CD-24	22 1/8"	23 1/8"
CD-25	23 1/8"	24 1/8"
CD-26	24 1/8"	25 1/8"
CD-27	25 1/8"	26 1/8"
CD-28	26 1/8"	27 1/8"
CD-29	27 1/8"	28 1/8"
CD-30	28 1/8"	29 1/8"
CD-31	29 1/8"	30 1/8"
CD-32	30 1/8"	31 1/8"
CD-33	31 1/8"	32 1/8"
CD-34	32 1/8"	33 1/8"
CD-35	33 1/8"	34 1/8"
CD-36	34 1/8"	35 1/8"

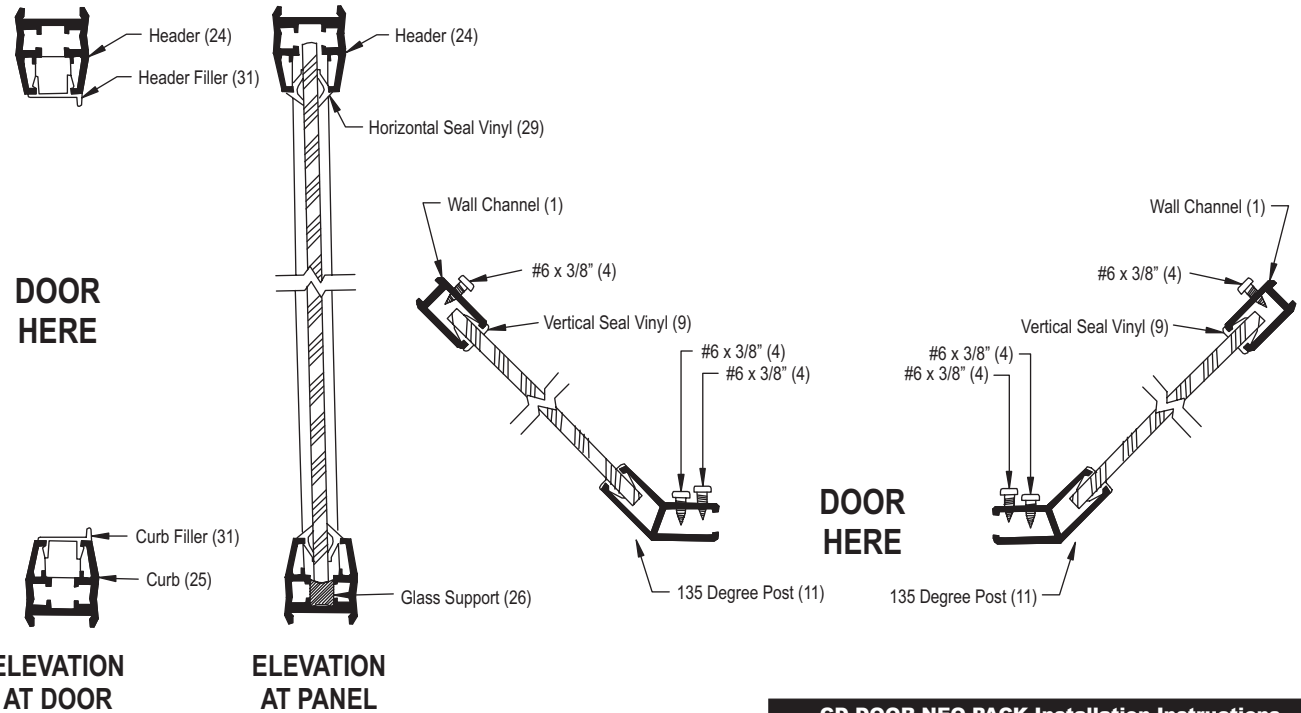

Cardinal
SHOWER ENCLOSURES



INSTALLATION INSTRUCTIONS

MODEL: **CD Door NEO Pack**

Neo Panel Pack for Cardinal Series
Continuous Hinge Swing Door

Frameless Enclosures

Model CD NEO Stall Shower - Door & 2 - 135 Degree Panels

Breakdown Chart for Special Height and Width CD NEO Units

QTY.	Part# & Description	How to arrive at measurement
3	ZSS 3101 Header	Unit width all sides
3	ZSS 3101 Curb	Unit width all sides
2	ZSS 1102 Filler	
2	ZSS 1105 135 Degree Post	Unit width minus 1 1/4"
2	ZD 1006 Wall Channel	Unit height minus 1 1/14" *
1	ZD 1004 Latch Jamb	Unit minus 2 3/8" *
1	ZD 2505 Hinge Jamb	Unit height 2 3/8" *
1	ZD 2503 Hinge Rail	Unit height 3 1/4" *
1	ZD 1002 Bottom Rail	Door glass width minus 11/16" *
1	ZD 1008 Drip Trough (see chart for door glass width) *These parts are from a CD	Door glass width minus 3/16" *
Panel Glass 1	width height	Unit width minus door width, minus 1" Unit height minus 1"